

# Buddy Bumper Installation

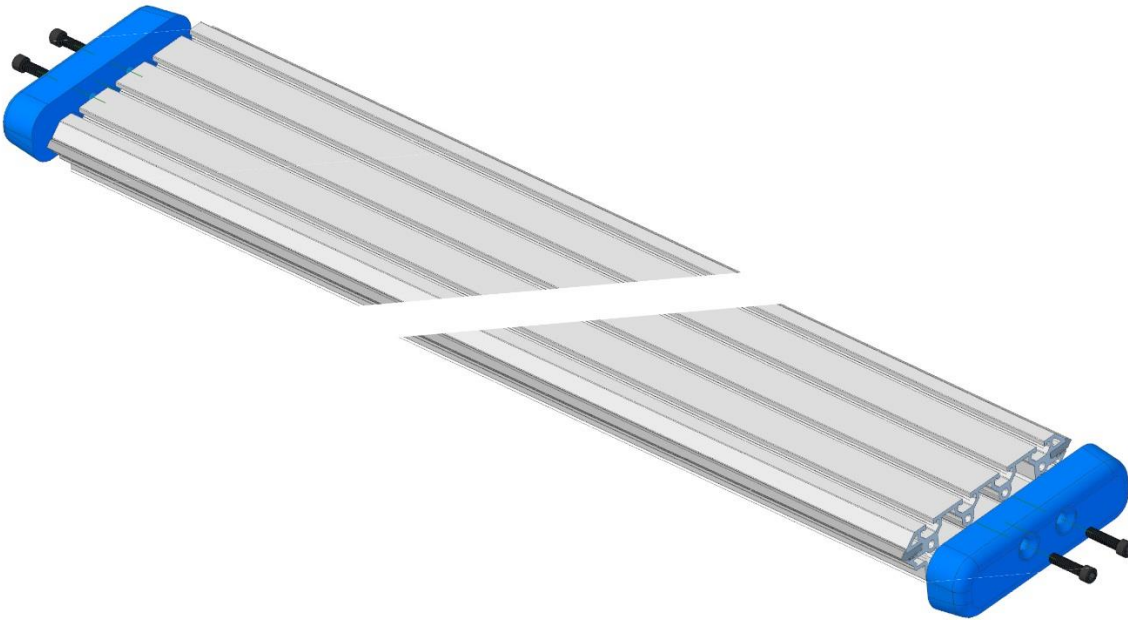

**ShopBot Tools, Inc.**  
3333-B Industrial Drive,  
Durham NC 27704  
ShopBotTools.com

**Technical Support**  
support@shopbottools.com  
1-888-680-4466

## Revision History

Date:	ECO:	Change:	Author:
2015 12 08		New Release	M. Cummings

## Table of Contents

Introduction .....	4
Installing the bumpers .....	4

## Introduction

The buddy bumpers create a physical barrier from the cutter. If a person is close to the Buddy Power Stick, the bumper will nudge them to ensure proper clearance and safety.

NOTE: When bumpers are installed, the powerstick can only be removed from the front side.

## Installing the bumpers

One of the bumpers has a notch cut into it. This bumper is the rear bumper.

Use  $\frac{1}{4}$ " allen wrench to install rear bumper (p/n 003301) onto rear side of powerstick with two screws (p/n 002018).

Use  $\frac{1}{4}$ " allen wrench to install front bumper (p/n 003300) onto front of powerstick with two screws (p/n 002018).

